

107-101 Sphere Anti-skate Stud



Above. Shown with machine polished finish

Description

Manufactured from 316 grade steel.

Satin polish finish as standard.

Constructed from non corrosive material.

M8 x 40mm stud to be resin fixed to concrete, stone or timber.

Dimensions

Ø35 x 57.5mm (L)

39mm Forward protrusion

4mm rad as standard

Options

304 Grade stainless steel - Bronze - Aluminium - Anodised Aluminium

Mirror polish finish - Sandblasted Finish - Anodise to any RAL colour

Specify required internal radius to suit edge of base product

Bespoke sizing

Full installation service - POA

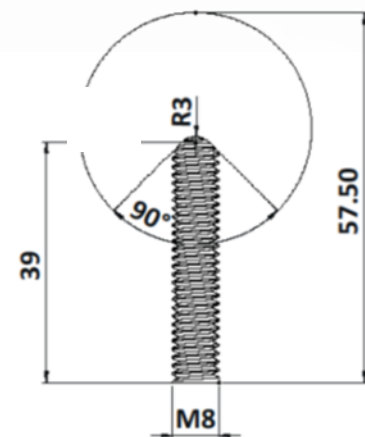
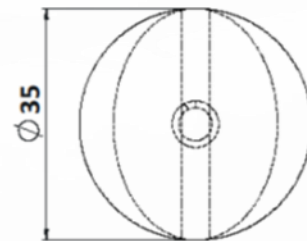

107-101 Sphere Anti-skate Stud Installation

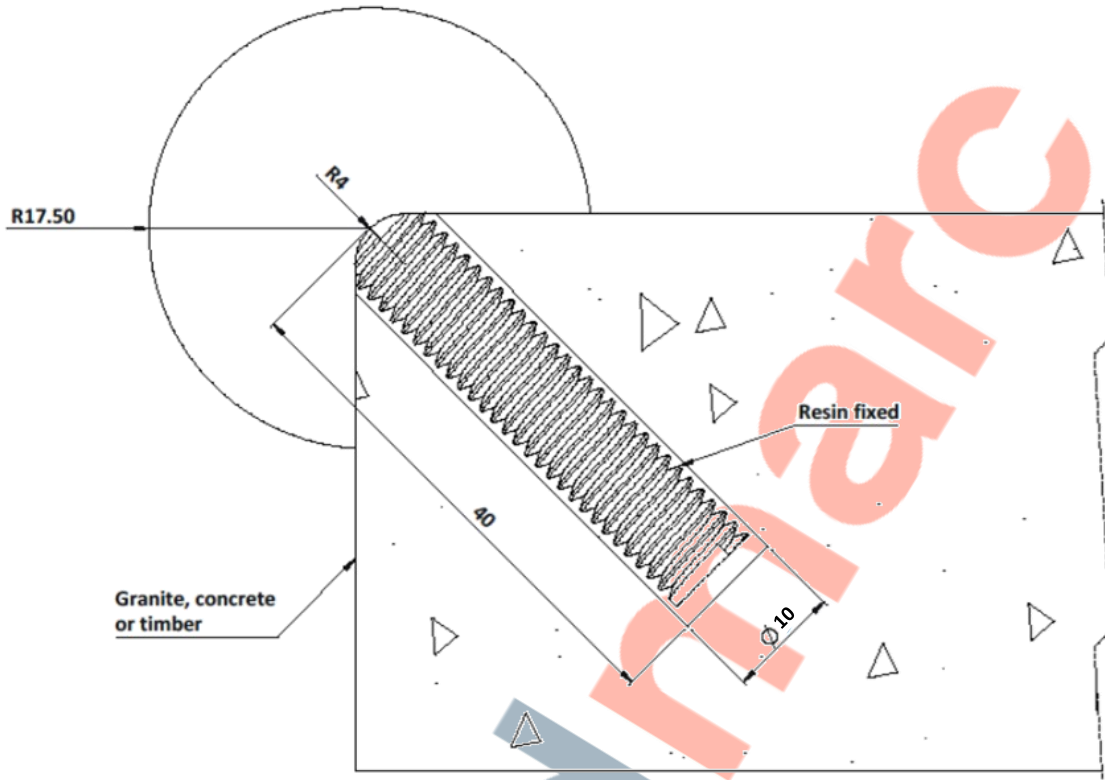

Installation

1. Drill holes 10mm in diameter to the depths shown above at a 45 deg. angle.
2. Remove dust and debris caused by drilling.
3. Following the product guidelines, found on the Resin tube, pour a sufficient amount to fill the drilled hole.
4. Push the stud into the hole firmly ensuring an edge seal around the entire stud
5. Allow a few minutes for the Polymer Modified Adhesive to set.

Cleaning & Maintenance

This product is designed for all weather exposure requiring only minimal maintenance as detailed below.

Stainless Steel: Manufactured from premium grade stainless steel. Maintenance free, inspect fixing every 6 months. Add additional Adhesive where required.

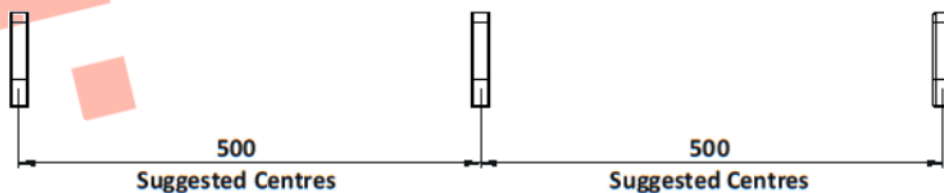

DATASHEET

107-101 Sphere Anti-skate Stud

